

TRIM MATERIAL COMBINATION (ON REQUEST)			
Trim NO.	Seat ring face Part No.2	Wedge Ring Face Part No.3	Stem Part No.11
1	F6a/13%Cr.	F6a/13%Cr.	F6a/AISI410
2	F304	F304	F304/ AISI304
5	STELLITE	STELLITE	F6a/AISI410
8	STELLITE	F6a/13%Cr	F6a/AISI410
9	MONEL	MONEL	MONEL
10	F316	F316	F306/AISI316
13	ALLOY 20	ALLOY 20	ALLOY 20

OTHER TRIM COMBINATION OF API 602 CAN BE PROVIDED ON REQUEST.

STANDARD MATERIAL COMBINATION											
S.NO.	PART NAME	Carbon steel to ASTM		Alloy steel to ASTM				Stainless steel to ASTM			
1	BODY	A105	A350 LF2	A182 F1	A182 F11	A182 F22	A182 F9	A182 F304	A182 F316	A182F304L	A182F316L
4	GASKET	Spiral wound Stainless steel Graphoil filled									
5	BONNET	A105	A350 LF2	A182 F1	A182 F11	A182 F22	A182 F9	A182 F304	A182 F316	A182 F316	A182F316L
6	STUDS	A193B7	A320 L7	A193 B7	A193 B7	A193 B16	A193 B16	A193 B8	A193B8	A193B8	A193B8
7	PACKING	To suit service conditions									
8	GLAND	A182 F6a	A182 F6a	A182 F6a	A182 F6a	A182 F6a	A182 F6a	F-304	F-316	F-304L	F-316L
9	GLAND FLANGE	A105	A350 LF2	A182 F1	A182 F11	A182 F22	A182 F9	A182 F304	A182 F316	A182F304L	A182F316L
10	NUTS	A194 2H	A194 Gr.4	A194 2H	A194 Gr.4	A194 Gr.4	A194 Gr.4	A194 Gr.8	A194 Gr.8	A194 Gr.8	A194 Gr.8
12	YOKE SLEEVE	Al. Bronze BS 1400 AB2C or Ni-resist to A439 D2									
13	HANDWHEEL	DI. A536 80-55-06 OR MI/A338									
14	STEM	A182 F6a	A182 F6a	A182 F6a	A182 F6a	A182 F6a	A182 F6a	F-304	F-316	F-304L	F-316L
15	HANDWHEEL RETAINING NUT	STEEL									
TEST PRESSURES											
CLASS	SHELL TEST		SEAT TEST								
			(HYDROSTATIC)		PNEUMATIC						
600	150 Bar g	2175 Psi g	110 Bar g	1595 Psi g	6.9 bar	100 Psi g					
800	207 Bar g	3002 Psi g	152 Bar g	2204 Psi g	6.9 bar	100 Psi g					
1500	373 Bar g	5410 Psi g	274 Bar g	3975 Psi g	6.9 bar	100 Psi g					
2500	639 Bar g	9270 Psi g	468 Bar g	6790 Psi g	6.9 bar	100 Psi g					
NOTE: The above data is subject to change without notice due to our continuing product improvement program.											

(01)



## JAYARAJ PIPE TRADERS

48/425 Q, JAYARAJ HOUSE, ELAMAKKARA, COCHIN 682 026  
 TEL. No. 0484 253 0785, 240 8008, 240 8009. FAX: 0484 253 0785  
 E-mail: jaypipescochin@gmail.com, sales@jayarajpipes.com  
 Web: www.jayarajpipes.com



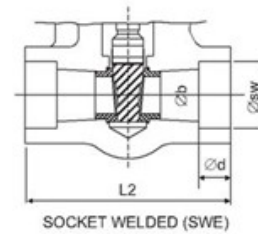
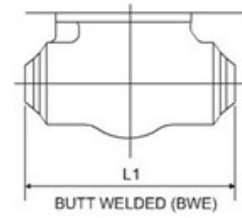
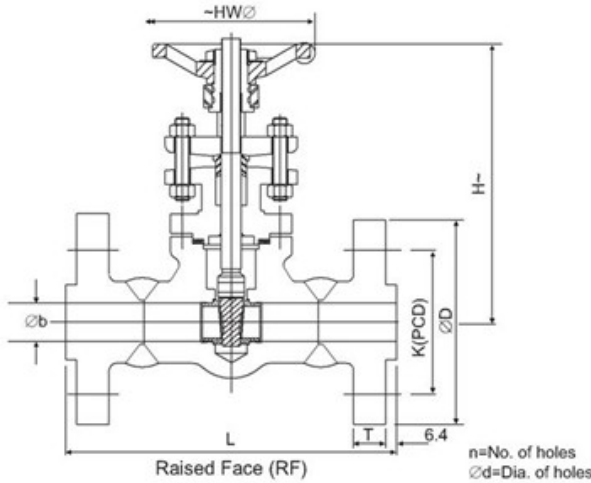

**DIMENSIONAL DATA CLASS - 600**

DN	NPS	L(RF)	$\phi D$	T	K(PCD)	n	$\phi d$	H	$\phi HW$	D	F	Aprox.Wt. <sup>^</sup>
15	1/2	165	95.5	14.2	66.5	4	15.7	145	90	11	6.4	3.97
20	3/4	190	117.5	15.8	82.5	4	19.1	170	95	14	6.4	7.18
25	1	216	124	17.5	88.9	4	19.1	192	108	14	6.4	9.26
32	1 1/4	229	133.5	20.6	98.5	4	19.1	220	125	14	6.4	--
40	1 1/2	241	155.5	22.4	114.3	4	22.3	220	125	14	6.4	16.260
50	2	292	165.1	25.4	127	8	19.1	252	125	17	6.4	20.340

**DIMENSIONAL DATA CLASS - 800**

DN	NPS	$\phi b$	L1(BWE)	L2(SWE)	H	$\phi HW$	BS 3799 $\phi SWE$	ASME B16.11	D	Aprox.Wt. <sup>^</sup>
15	1/2	9.5	80	80	128	83	21.8 <sup>+0.3</sup> <sub>-0.0</sub>	22.2	11	1.6
20	3/4	12.5	88	88	150	90	27.4 <sup>+0.3</sup> <sub>-0.0</sub>	27.6	14	2.1
25	1	18	100	100	165	96	34.1 <sup>+0.3</sup> <sub>-0.0</sub>	34.3	14	3.15
32	1 1/4	24	114	114	192	108	42.9 <sup>+0.3</sup> <sub>-0.0</sub>	43.1	14	4.92
40	1 1/2	31	104	104	222	125	49 <sup>+0.3</sup> <sub>-0.0</sub>	49.2	14	5.8
50	2	37	116	116	245	125	61 <sup>+0.3</sup> <sub>-0.0</sub>	61.7	17	9.450

NOTE: The above data is subject to change without notice due to our continuing product improvement program. (<sup>^</sup>WEIGHT GIVEN IN KGS)

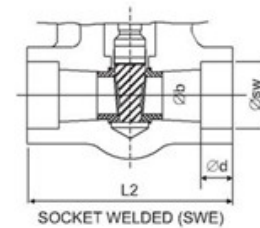
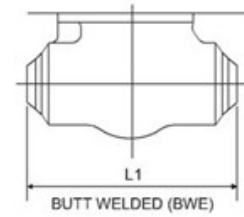
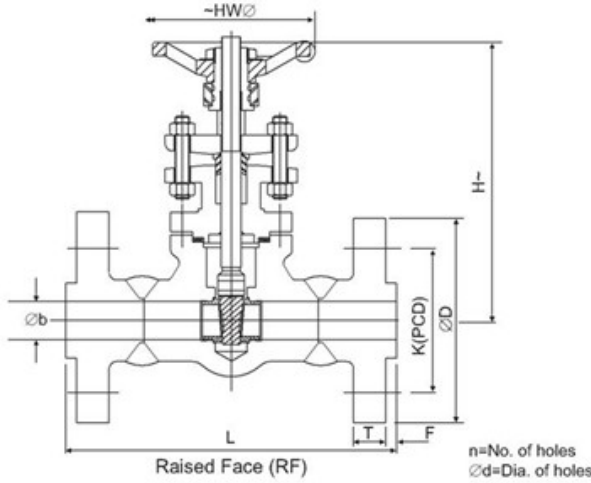

**DIMENSIONAL DATA CLASS - 1500**

DN	NPS	$\phi b$	L1(BWE)	L2(SWE)	H	$\phi HW$	$\phi SWE$		D	Aprox.Wt. <sup>^</sup>
							BS 3799	ASME B16.11		
15	1/2	11.5	100	100	170	95	+0.3 21.8 -0.0	22.2 21.8	11	3.165
20	3/4	15	114	114	192	108	+0.3 24.8 -0.0	27.6 27.2	14	5.055
25	1	19.5	104	104	225	125	+0.3 34.1 -0.0	34.3 33.9	14	6.28
40	1 1/2	27	116	116	245	125	+0.3 49 -0.0	49.2 48.8	14	11.78
50	2	40	130	130	325	200	+0.3 61 -0.0	61.7 61.2	17	--

**DIMENSIONAL DATA CLASS - 2500**

DN	NPS	$\phi b$	L1(BWE)	L2(SWE)	H	$\phi HW$	$\phi SWE$		D	Aprox.Wt. <sup>^</sup>
							BS 3799	ASME B16.11		
15	1/2	12	130	130	300	127	+0.3 21.8 -0.0	22.2 21.8	11	8.77
20	3/4	15	130	130	300	127	+0.3 27.4 -0.0	27.6 27.2	14	9.79
25	1	19	130	130	300	127	+0.3 34.1 -0.0	34.3 33.9	14	10.47

NOTE: The above data is subject to change without notice due to our continuing product improvement program. (<sup>^</sup>WEIGHT GIVEN IN KGS)

(03)



**JAYARAJ PIPE TRADERS**

48/425 Q, JAYARAJ HOUSE, ELAMAKKARA, COCHIN 682 026  
 TEL. No. 0484 253 0785, 240 8008, 240 8009. FAX: 0484 253 0785  
 E-mail: jaypipescochin@gmail.com, sales@jayarajpipes.com  
 Web: www.jayarajpipes.com

